



Cargo Control





CARGO CONTROL TABLE OF CONTENTS

	Page
Cam Buckle	10
Chain Grade 70 Tie down	1
Chain Tails	2
Corner Protectors	7
D Ring Weld On Hinges	9
Lashing Winches	4
Overcenter Buckle	11
Ratchet Buckle	12
Sliding Winches	5
Strap Hooks	13
Tarp Straps	8
Trailer Safety Chains	3
Vinyl Covered S Hooks	14
Winch Bars	6



Grade 70 Tie Down Assemblies

Grade 70 transport chain is designed for use in cargo securement, towing and logging. Supplied with Alloy Grab hooks on each end. Manufactured in accordance to Department of Transport regulations.



Chain Size	Length (ft)	Weight (lbs)	WLL (lbs)	Product Code
5/16"	16	16.00	4,700	38072016
5/16"	20	20.00	4,700	38072020
5/16"	25	25.00	4,700	38072025
3/8"	10	17.00	6,600	38072410
3/8"	12	19.00	6,600	38072412
3/8"	14	22.00	6,600	38072414
3/8"	16	25.00	6,600	38072416
3/8"	20	31.00	6,600	38072420
3/8"	25	38.00	6,600	38072424

Material Grade 70 Chain, Alloy Hooks

Finish Yellow Chromated

Design Factor 4 : 1

Chain can be supplied in bulk or as tie down assemblies.

WARNING:

Never exceed working load limits

Do not use grade 70 chains for lifting applications



18" Chain Tails - Grade 70



Chain Size	Model	Web Width	WLL (lbs)	Product Code
5/16"	S-925	2"	3,335	37054010
5/16"	S-328	3"	5,500	37055000
3/8"	S-926	3"	6,000	37054011
3/8"	S-927	4"	6,600	37054012

Material Grade 70 Chain, Alloy Hooks, Forged Alloy Delta Ring
Finish Yellow Chromated
Design Factor 3 : 1

WARNING: Never exceed working load limits
Do not use grade 70 chains for lifting applications



2" Lashing Winches

Sturdy construction winches provide a method for securing cargo on flatbed trailers, rail cars and other vehicles.

Lashing winches, for use with 2" webbing can be welded or bolted onto a trailer.

Winch design offers similar features of a ratchet buckle with its quick release

Hex drive style requires a 1-1/8" hex head wrench or socket.



Type	WLL (lbs)	Nominal Dimension Inches							Weight (lbs)	Product Code
		A	B	C	D	E	F			
Hex Key	3,660	3.000	4.00	2.187	3.250	1.062	0.500	3.55	37051000	

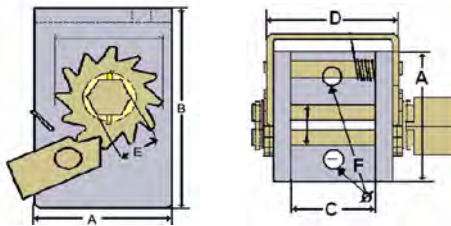

WARNING:

Make sure that webbing is inserted min 4" into slot on mandrel and wrapped 2 - 3 times around mandrel before tightening.
 Do not use extensions with winch bars
 Do not release winch bars without prior checking that ratchet pawls are properly engaged.
 Hold winch bars tightly to avoid bars from slipping out of your hands
 Excessive webbing on winches reduces working load limits



Standard Sliding Winches

Sturdy construction winches provide a method for securing cargo on flatbed trailers, rail cars and other vehicles

All sliding winches can also be welded in place for fixed application.



Type	WLL (lbs)	Nominal Dimension Inches							Product Code
		A	B	C	D	E	F	G	
Standard with flange	5,400	6.750	4.00	2.500	8.250	4.500	1.750	1.000	37051020
Standard without flange	5,400	6.750	4.00	2.500	8.250	4.500	1.750	1.000	37051021
Standard with flange and handle	5,400	6.750	4.00	2.500	8.250	4.500	1.750	1.000	37051063
Standard with handle no flange	5,400	6.750	4.00	2.500	8.250	4.500	1.750	1.000	37051065



WARNING:

Make sure that webbing is inserted min 12" into slot on mandrel and wrapped 2 - 3 times around mandrel before tightening.

Do not use extensions with winch bars

Do not release winch bars without prior checking that ratchet pawls are properly engaged.

Hold winch bars tightly to avoid bars from slipping out of your hands

Excessive webbing on winches reduces working load limits



Winch Bars

Winch bars are used to tighten and secure winch straps in winches. Non-slip handle and tapered tip for better grip. Combination winch bars have a boxed end for tightening winch straps and lever style chain binders.



Type	Nominal Dimension Inches							Weight (lbs)	Product Code
	A	B	C	D	E	F			
Standard Black	29.00	1.30	3.70	0.98	3.94		5.30	37030060	
Standard Chrome	29.00	1.30	3.70	0.98	3.94		5.95	37030061	
Combination Bar	37.00	1.30	3.70	0.98	11.00	5.00	5.95	37030062	



WARNING: Always hold winch bars firmly when tightening or loosening straps
 Before removing winch bars ensure that the ratchet pawl is fully engaged
 Do not use extensions with winch bars
 When tightening or loosening straps make sure that the nose of winch bar is fully inserted into holes of winch drums.
 Keep bystanders in safe distance when tightening or loosening straps.

Corner Protectors

Protects cargo when using chain or webbing to secure your load.



Chain
Metal protector



Web
Metal protector



Web
Plastic protector

Type	Size	Nominal Dimension Inches			Product Code
		A	B	C	
Plastic Corner Protector	2-4"	4.3	5.3	4.1	37030048
Chain Corner Protector	2"	4.7	5.9		37030040
Steel Webbing Protector	3"	4.3	6.5		37030043
Steel Webbing Protector	4"	4.3	7.5		37030045

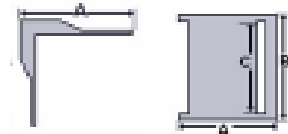

WARNING: Do not use plastic corners for chains
Make sure that webbing or chains slide properly over corner protectors



Tarp Straps with Galvanized S-Hooks

Tarp straps, also known as "tarp tie-downs", are an important tool in helping to keep cargo and tarps in place. They are ideal for use on the tarps used to cover vehicles, machinery, boats, and truck loads



Type	Nominal Dimension Inches		Product Code
	Length	Max. Stretch	
100 % Natural Rubber			
Black	4	6	37080004
Black	9	14	37080009
Black	15	23	37080015
Black	21	32	37080021
Black	31	47	37080031
Black	41	62	37080041
EDPM			
Arctic Blue	9	14	37081009
Arctic Blue	15	23	37081015
Arctic Blue	21	32	37081021
Arctic Blue	31	47	37081031



- Material** Branded straps available in either 100 % natural rubber or synthetic EDPM. Supplied with S hooks attached.
- Design** UV and Ozone inhibitors for better resistance to cracking. For conditions with extreme atmospheric Ozone levels (high pollution in temperatures between -2 to +3 we recommend EDPM straps with increased resistance against corrosion.
- Stretch** 150 % of nominal length

WARNING: Tying tarp straps over sharp edges shortens the service life
 Do not tie knots in tarp straps
 Do not extend over safe stretch (150 %)
 Inspect straps frequently, replace cracked straps



D-Rings with Bolt-on Hinges

The Bolt on D-Ring is perfect when a welded (permanent) lashing point is undesirable, D-Rings as well as weld rings and rope rings make for an excellent anchor for mounting to the bed of your work truck or sides of your truck for assisting with cargo control and cargo tie-downs

Great for recovery points on a custom bumper or securing loads on a trailer



Size	Nominal Dimension Inches										WLL (lbs)	Product Code
Inches	A	B	C	D	E	F	G	H	R ¹	R ²		
2.25 x 2.5 x 0.5	2.250	2.500	0.500	0.625	3.125	2.000	0.375	2.000	1.500	0.250	4,000	37051010

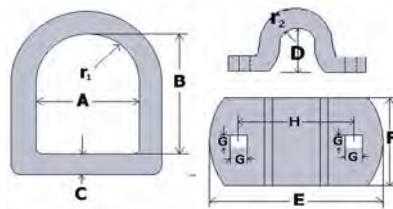

Material Drop forged carbon steel, quenched and tempered
 Finish Strong bolt on hinges, yellow chromated
 Design Factor 3 : 1

WARNING: Use bolts of adequate size and strength only
 Secure bolts with washers and lock washers
 Torque-tighten bolts
WORKING LOAD LIMITS ARE FOR STRAIGHT IN-LINE PULLS ONLY



D-Rings with Weld-on Hinges

These D-Rings make an excellent anchor for winching, tie downs and blocking. They are drop forged and come with a U-shaped mounting bracket which must be welded in place. Great for recovery points on a custom bumper or securing loads on a trailer.



Size	Nominal Dimension									WLL (lbs)	Product Code
	Inches										
Inches	A	B	C	D	E	F	G	R ¹	R ²		
3 x 3 x 5/8	3.000	3.000	0.625	0.875	2.500	1.000	0.375	1.500	0.375	6,000	37050015
3 x 4 x 1	3.000	4.000	1.000	1.325	2.562	1.312	0.500	1.500	0.562	12,000	37050014

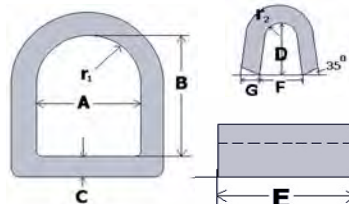

- Material: Drop forged carbon steel, quenched and tempered
- Finish: Self colored, ready to be welded on truck body
Hinges are beveled 35 ° for proper weld penetration
- Design Factor: 3 : 1
- Welding: For best welding results use BONARC E 7018 coated electrodes or BONARC ER 70 S 6 welding Wire

WARNING: Weld file on hinges must be over the entire length of the hinge (dim. "E") with a minimum penetration on the truck frame of 1/8". Before welding, make sure that all contaminants like rust, oil, paint, galvanization are removed from welding area. **WORKING LOAD LIMITS ARE FOR STRAIGHT IN-LINE PULLS ONLY**

Cam Buckles

For easy and quick tying down of loads



Cam Buckle		Nominal Dimension Inches				Product Code
WLL (lbs)		A	B	C	D	
230		1.00	1.28	1.95	0.60	37015000
660		2.13	2.40	3.07	0.94	37015001
200		1.00	1.18	1.73	0.47	37015002

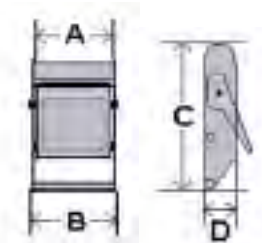

Sturdy Construction for additional tension on straps
 Die-cast, solid construction
 Large model with steel base
 For 1" and 2" wide straps
 Design Factor 3 : 1

WARNING: Do not use straps that are cut, frayed or otherwise damaged
 Protect straps from sharp corners or edges with corner protectors
 The total mass/weight of the load shall not exceed the aggregate
 working load limit of all tie-downs
 Keep cam buckles clean and lubricated



Overcentre Buckles

For tightening and tensioning straps



Overcenter Buckle Type	WLL (lbs)	Nominal Dimension Inches			Product Code
		A	B	C	
GOLD DYE-CHROMATED	1,860	6.75	2.5	4.12	37014020
STAINLESS STEEL	1,100	6.14	2.36	3.62	37014050

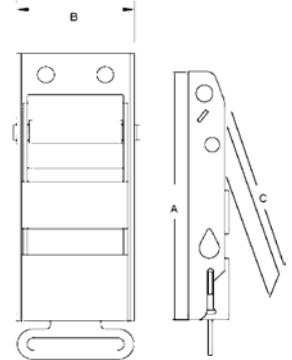

- Sturdy Construction for additional tension on straps
- Gold Dye-chromated finish or chrome-nickel stainless steel
- Low wear to straps
- Positive locking features
- Design Factor 3 : 1

WARNING: Do not use straps that are cut, frayed or otherwise damaged
 Protect straps from sharp corners or edges with corner protectors
 Keep overcentre buckles clean and lubricated



Ratchet Buckles

For tightening and tensioning straps



R. Buckle WLL (lbs)	Nominal Dimension Inches							Product Code
	A	B	C	D	D1	E	F	
1,000	1.18	1.85	3.66	2.36	2.20	2.24	3.27	37011003
3,660	2.05	2.95	5.51	3.03	2.68	3.66	4.56	37012004
3,660	2.05	2.95	6.69	4.02	3.66	3.66	4.53	37012006
3,660	2.05	2.95	7.68	4.02	3.66	3.66	4.53	37012011
7,300	3.03	4.88	11.42	4.57	4.13	5.47	7.09	37013001

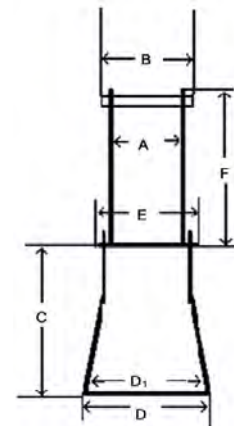

- Sturdy Construction
- Different handle widths and lengths
- Gold Dye-chromated finish
- Design Factor 3 : 1

WARNING: Make sure that webbing is wrapped 2-3 times around reel before tightening
 Do not use handle extensions or extension bars
 Do not use straps that are cut, frayed or otherwise damaged
 Protect straps from sharp corners or edges with corner protectors
 The total mass/weight of the load shall not exceed the aggregate working load limit of all tie-downs
 Keep ratchet buckles clean and lubricated



Strap Hooks

A variety of yellow chromated hooks for webbing

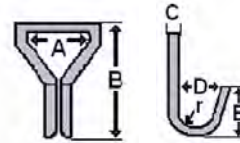

Type	Size	WLL (lbs)	Nominal Dimension Inches						Product Code
			A	B	C	D	E	F	
Narrow Wire Hook	1	800	1.062	2.375	0.250	1.000	1.250		37030006
Narrow Wire Hook	2	1,660	2.000	3.250	0.312	1.062	1.312		37030009
Narrow Wire Hook	2	3,350	2.000	3.250	0.500	1.187	1.312		37030008

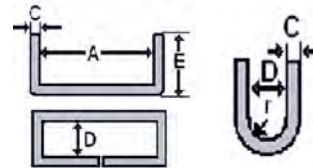

Closed Hook	2	2250	1.000	0.375	0.940				37030203
-------------	---	------	-------	-------	-------	--	--	--	----------

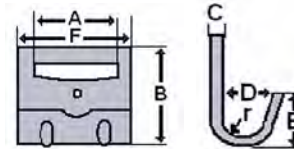

Flat Hook	2	3,335	1.75	3.50	0.187	0.450	0.875	2.250	37030015
Flat Hook	3	5,000	2.75	3.88	0.187	0.780	1.750	3.625	37030005

WARNING:

Do not use straps that are cut, frayed or otherwise damaged
 Protect straps from sharp corners or edges with corner protectors
 The total mass/weight of the load shall not exceed the aggregate working load limit of all tie-downs
WORKING LOAD LIMITS ARE FOR STRAIGHT LINE PULLS ONLY



Vinyl Covered Hooks

Strong S-Hooks, covered with black vinyl, for use where hooks are touching delicate surfaces



Type	WLL (lbs)	Nominal Dimension Inches					Product Code
		A	B	C	D	E	
1" S-Hook	800	1.062	2.375	0.250	1.000	1.250	37030019
2" S-Hook	1,800	2.000	3.250	0.312	1.062	1.312	37030017

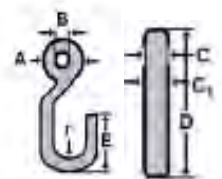

WARNING: Do not use straps that are cut, frayed or otherwise damaged
 Protect straps from sharp corners or edges with corner protectors
 The total mass/weight of the load shall not exceed the aggregate working load limit of all tie-downs
WORKING LOAD LIMITS ARE FOR STRAIGHT IN-LINE PULLS ONLY