



TOOLS

# TOOLS



[www.vanguardsteelvancouver.com](http://www.vanguardsteelvancouver.com)

[www.vanguardsteel.com](http://www.vanguardsteel.com)

**VANGUARD STEEL LTD.**

TOOLS



# TOOLS TABLE OF CONTENTS

	Page
Bolt Cutters	1
Chain Pliers	2
Chain Tensioner	3
Felco Cable Cutters	4
Felco Spare Parts	5
Felco C-7	6
Felco C-9	7
Felco C-12	8
Felco C-16	9
Felco C-108	10
Felco C-112	11
RC 8 Cable Cutter	12
Swagers	13
Swaging Instructions	14

# Bolt Cutter

Blade clearance adjustable with eccentric nut.  
 Heavy duty blades with satin finish.  
 Suitable for cutting mild steel only!



Bolt cutters		Length (inches)	Weight lbs/pc	Product Code
Capacity (inches)				
3/16		14.00	3.00	30040014
1/4		18.00	5.50	30040018
5/16		24.00	8.60	30040024
3/8		30.00	10.00	30040030
7/16		36.00	13.00	30040036
1/2		42.00	18.00	30040042

- \*All purpose jaws, with center-cut blades.
- \*High-carbon machined steel jaws, cuts rods, bolts, rivets, bars and chain.
- \*Tubular steel handles with comfortable rubber handles for gripping firmly and safely.
- \*Jaws are adjustable.

**THESE TOOLS ARE CAPABLE OF INFLECTING SERIOUS INJURY.  
 KEEP HANDS AND FEET AWAY FROM THE JAWS AND OTHER MOVING PARTS.**

## Tire Chain Pliers

Industrial grade chain pliers allow for easy replacement of cross chains.



Tire Chain Pliers Model		Length (inches)	Weight lbs/pc	Product Code
VGD-02		20-3/4	5.00	40040020
VGD-01		32-1/2	7.00	40040030



- \*Heat Treated alloy steel jaws.
- \*Opens and closes tire chain cross links.
- \*Toggle joints turn 50 lb. hand pressure to 4000 lb. cutting pressure.
- \*Tubular steel handles with comfortable rubber handles for gripping firmly and safely.
- \*Makes repairs quickly and easily.

**KEEP JAW BOLTS TIGHT AND JOINTS OILED AT ALL TIMES !**

**THESE TOOLS ARE CAPABLE OF INFLICTING SERIOUS INJURY.  
KEEP HANDS AND FEET AWAY FROM THE JAWS AND OTHER MOVING PARTS.**

# Chain Tensioner



Chain Tensioner Model	Weight lbs/pc	Product Code
VSCT	12.00	38199001





A Heavy Duty Tool with ratchet binder action for installation and tensioning of large tractor and skidder tire chains. Greatly simplifies and eases the proper installation and tensioning of snow chains.

**THESE TOOLS ARE CAPABLE OF INFLECTING SERIOUS INJURY. KEEP HANDS AND FEET AWAY FROM THE JAWS AND OTHER MOVING PARTS.**

# Cable Cutters

The tools for 'professionals' cutting wire rope, steel rod or wire, offering precision cutting capabilities.

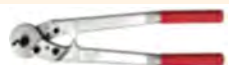

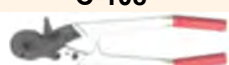
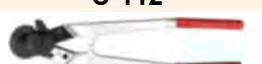
Cable Cutters					
Model	Application	Max. Diameter	Overall Length	Weight lbs/pc	Product Code
	Mild Steel Strand	1/4"	8	0.63	30010007
	High Tensile Steel Strand	3/16"			
	Hard Drawn Steel Spring Wire	3/32"			
	Mild Steel & Barbed Wire	3/16"			
	Wire Ropes & Strands	3/16"	13	1.63	30010009
	Mild Steel Strands	3/16"			
	High Tensile Strands, Steel Rods	11/32"			
	Wire Ropes & Strands	3/8"	19	3.00	30010012
	Steel Rods	5/16"			
	Tempered Spring Wire	5/32"			
	Wire Ropes & Strands	5/8"	23	5.00	30010016
	Steel Rods	7/16"			
	Tempered Spring Wire	3/16"			
	High Tensile Strands, Steel Rods	5/16"	22	4.50	30010108
	Tempered Spring Wire	1/4"			
	High Tensile Strands, Steel Rods	1/2"	28	8	30010112
	Tempered Spring Wire	5/16"			

**C-108 & C-112 Cutters** are featuring Felco's unique Reduction Gearing System, providing maximum force transmission by intensifying the users' energy.

\*Strong, lightweight aluminum handles and special alloy steel blades for outstanding performance.

\*Cutting capacity optimized by the shape of the handles.

\*Special rust protection for all parts of the cutters.

**THESE TOOLS ARE SHARP AND SHOULD BE USED WITH CAUTION !  
USING THEM BEYOND THE STATED CAPACITY OR ON OTHER PRODUCTS  
WILL DAMAGE THE BLADES AND TOOL !**

## Spare Parts for Cable Cutters



Cable Cutters	Model	Product Code
---------------	-------	--------------

	C108		
	C108/2	Handle With Plastic & Pin	30020218
	C108/3	Plastic for handle	30020318
	C108/4	Pin	30020418
	C108/5	Fixed Spare Blade	30020518
	C108/6	Center Bolt	30020618
	C108/8	Nut	30020818
	C108/9	Counter nut	30020918
	C108/10	Hex Screw	30021018
	C108/11	Counter nut	30021118
	C108/12	Cam	30021218
	C108/13	Finger	30021318
	C108/14	Lever with 2 Pins	30021418
	C108/15	Pin for Cam	30021518
	C108/16	Pin for Finger	30021618
C108/17	Mobile spare blade	30021718	

	C-112		
	C112/2	Handle With Coating & Pin	30020220
	C112/4	Pin	30020420
	C112/5	Fixed Spare Blade	30020520
	C112/6	Center Bolt	30020620
	C112/7	Washer for Bolt	30020720
	C112/10	Hexagon Screw	30021020
	C112/12	Cam	30021220
	C112/13	Finger	30021320
	C112/14	Lever with 2 pins	30021420
	C112/16	Pin for finger and Cam	30021620
	C112/17	Mobile spare blade	30021720
	C112/18	Connecting Rod	30021820
	C112/19	Bolt for Lever	30021920
	C112/20	Washer	30022020
C112/21	Nut	30022120	
C112/22	Counter Nut	30022220	

## Cable Cutter C-7



The tools for **'professionals'**

Gives a clean cut without squashing thanks to the triangular cutting system / blades and centre. Blades and center bolt in high-quality hardened steel for exceptional performance.

Thumb catch designed for one-handed operation.

Pressed steel handles with non-slip grips.



Model	Application	Max. Diameter	Overall Length	Weight lbs/pc	Product Code
	Mild Steel Strand	1/4"	8	0.63	30010007
	High Tensile Steel Strand	3/16"			
	Hard Drawn Steel Spring Wire	3/32"			
	Mild Steel & Barbed Wire	3/16"			

## Spare Parts for Cable Cutters

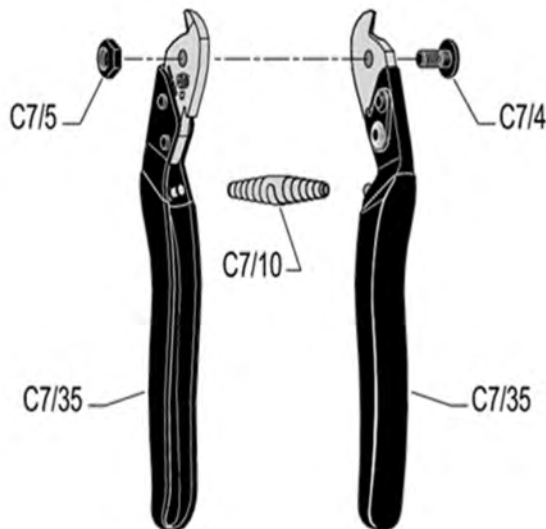

C 7/4	Bolt	<b>30020407</b>
C 7/5	Counter Nut	<b>30020907</b>
C 7/10	Spring	<b>30021907</b>
C 7/35	Non Slip Handle	<b>30020907</b>

**THESE TOOLS ARE SHARP AND SHOULD BE USED WITH CAUTION !  
USING THEM BEYOND THE STATED CAPACITY OR ON OTHER PRODUCTS  
WILL DAMAGE THE BLADES AND TOOL !**



## Spare Parts for Cable Cutters



The tools for '**professionals**'

Gives a clean cut without squashing thanks to the triangular cutting system .

Strong, lightweight aluminum handles and special alloy steel blades for outstanding performance.

Cutting capacity optimized by the shape of the handles.

Special rust protection for all parts of the cutters.



Model	Application	Max. Diameter	Overall Length	Weight lbs/pc	Product Code
<b>C-9</b>	Wire Ropes & Strands	3/16"	13	1.63	30010009
	Mild Steel Strands	3/16"			
	High Tensile Strands, Steel Rods	11/32"			

## Spare Parts for Cable Cutters

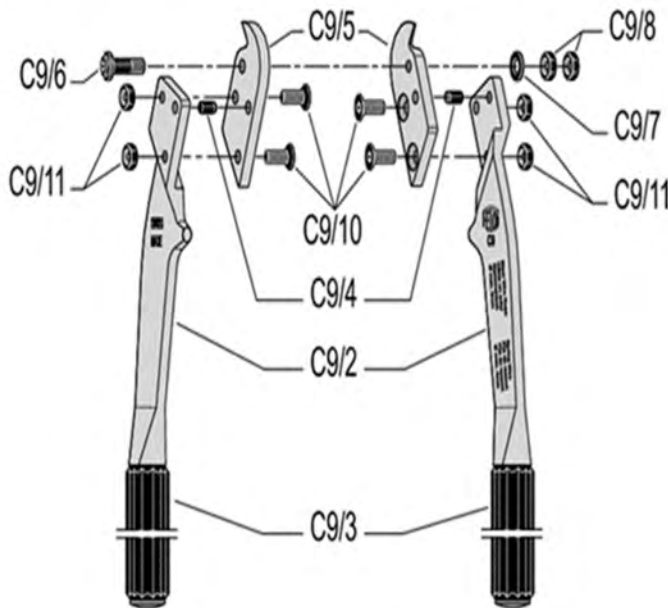

C9/2	Handle With Plastic & Pin	30020209
C9/3	Plastic for handle	30020309
C9/4	Pin	30020409
C9/5	Blade	30020509
C9/90	Center Bolt Repair Set	30023099
Cons. Of	C9/6; C9/7; C9/8	
C9/10	Hex Screw	30021009
C9/11	Counter Nut	30021109

**THESE TOOLS ARE SHARP AND SHOULD BE USED WITH CAUTION !  
 USING THEM BEYOND THE STATED CAPACITY OR ON OTHER PRODUCTS  
 WILL DAMAGE THE BLADES AND TOOL !**

# Cable Cutter C-12



The tools for '**professionals**'

Gives a clean cut without squashing thanks to the triangular cutting system .

Strong, lightweight aluminum handles and special alloy steel blades for outstanding performance.

Cutting capacity optimized by the shape of the handle.

Special rust protection for all parts of the cutters.



Model	Application	Max. Diameter	Overall Length	Weight lbs/pc	Product Code
 C-12	Wire Ropes & Strands	3/8"	19	3.00	30010012
	Steel Rods	5/16"			
	Tempered Spring Wire	5/32"			

## Spare Parts for Cable Cutters

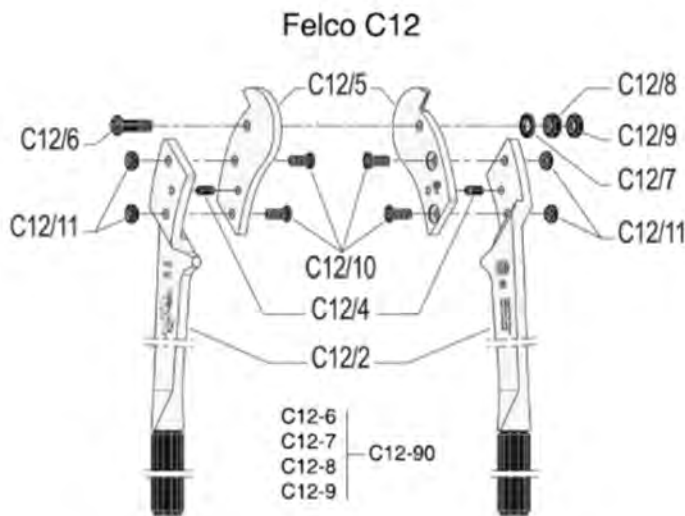

C12/2	Handle With Plastic & Pin	30020212
C12/3	Plastic for handle	30020312
C12/4	Pin	30020412
C12/5	Blade	30020512
C12/90	Center Bolt Repair Set	30023129
Cons. Of	C12/6; C12/7; C12/8; C12/9	
C12/10	Hex Screw	30021012
C12/11	Counter Nut	30021112

**THESE TOOLS ARE SHARP AND SHOULD BE USED WITH CAUTION !  
 USING THEM BEYOND THE STATED CAPACITY OR ON OTHER PRODUCTS  
 WILL DAMAGE THE BLADES AND TOOL !**

## Cable Cutter C-16



The tools for '**professionals**'

Gives a clean cut without squashing thanks to the triangular cutting system .

Strong, lightweight aluminum handles and special alloy steel blades for outstanding performance.

Cutting capacity optimized by the shape of the handle.

Special rust protection for all parts of the cutters.



Model	Application	Max. Diameter	Overall Length	Weight lbs/pc	Product Code
<b>C-16 *</b>	Wire Ropes & Strands	5/8"	<b>23</b>	<b>5.00</b>	<b>30010016</b>
	Steel Rods	7/16"			
	Tempered Spring Wire	3/16"			
			* Available for Electrical Cable C-16E		

## Spare Parts for Cable Cutters

Felco C16

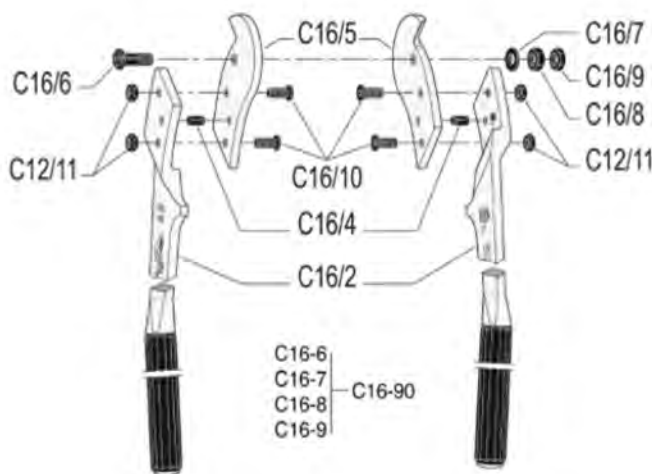

C16/2	Handle With Plastic & Pin	30020216
C16/3	Plastic for handle	30020316
C16/4	Pin	30020416
C16/5	Blade	30020516
C16/90	Center Bolt Repair Set	30023169
Cons. Of	C16/6; C16/7; C16/8; C16/9	
C16/10	Hex Screw	30021016
C12/11	Counter Nut	30021112

**THESE TOOLS ARE SHARP AND SHOULD BE USED WITH CAUTION !  
USING THEM BEYOND THE STATED CAPACITY OR ON OTHER PRODUCTS  
WILL DAMAGE THE BLADES AND TOOL !**

# Cable Cutter C-108



The tools for '**professionals**'

Gives a clean cut without squashing thanks to the triangular cutting system .

Strong, lightweight aluminum handles and special alloy steel blades for outstanding performance.

Cutting capacity optimized by the shape of the handle.

Special rust protection for all parts of the cutters.



Model	Application	Max. Diameter	Overall Length	Weight lbs/pc	Product Code
 <b>C-108</b>	High Tensile Strands, Steel Rods	5/16"	22	4.50	30010108
	Tempered Spring Wire	1/4"			

## Spare Parts for Cable Cutters

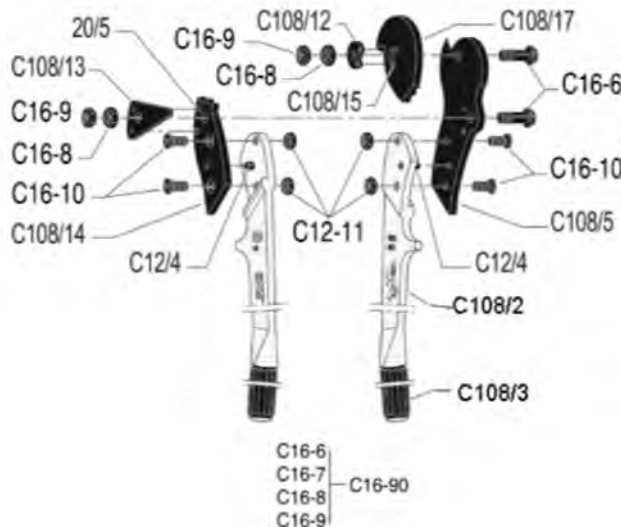

C108/2	Handle With Plastic & Pin	30020218
C108/3	Plastic for handle	30020318
C12/4	Pin	30020412
C108/5	Fixed Spare Blade	30020518
C16/90	Center Bolt Repair Set	30023169
Cons. Of	C16/6; C16/7; C16/8; C16/9	
C16/10	Hex Screw	30021016
C12/11	Counter nut	30021112
C108/12	Cam	30021218
C108/13	Finger	30021318
C108/14	Lever with 2 Pins	30021418
C108/15	Pin for Cam	30021518
C108/17	Mobile spare blade	30021718

**THESE TOOLS ARE SHARP AND SHOULD BE USED WITH CAUTION !  
 USING THEM BEYOND THE STATED CAPACITY OR ON OTHER PRODUCTS  
 WILL DAMAGE THE BLADES AND TOOL !**

# Cable Cutter C-112



The tools for **'professionals'**

Gives a clean cut without squashing thanks to the triangular cutting system .

Strong, lightweight aluminum handles and special alloy steel blades for outstanding performance.

Cutting capacity optimized by the shape of the handle.

Special rust protection for all parts of the cutters.



Model	Application	Max. Diameter	Overall Length	Weight lbs/pc	Product Code
 <b>C-112</b>	High Tensile Strands, Steel Rods	1/2"	<b>28</b>	<b>8</b>	<b>30010112</b>
	Tempered Spring Wire	5/16"			

## Spare Parts for Cable Cutters

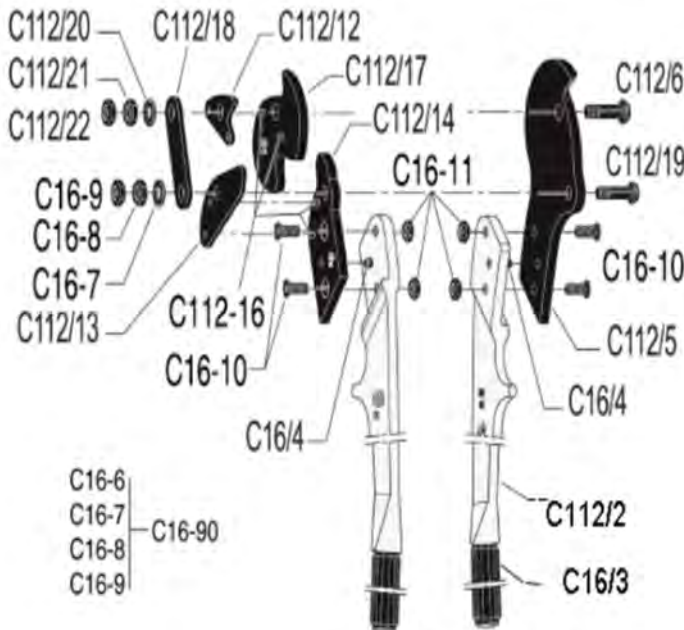

C112/2	Handle With Coating & Pin	30020220
C16/3	Plastic for handle	30020316
C16/4	Pin	30020416
C112/5	Fixed Spare Blade	30020520
C112/6	Center Bolt	30020620
C16/90	Center Bolt Repair Set	30023169
Cons. Of	C16/6; C16/7; C16/8; C16/9	
C16/10	Hexagon Screw	30021016
C112/12	Cam	30021220
C112/13	Finger	30021320
C112/14	Lever with 2 pins	30021420
C112/17	Mobile spare blade	30021720
C112/18	Connecting Rod	30021820
C112/19	Bolt for Lever	30021920
C112/20	Washer	30022020
C112/21	Nut	30022120
C112/22	Counter Nut	30022220

**THESE TOOLS ARE SHARP AND SHOULD BE USED WITH CAUTION !  
 USING THEM BEYOND THE STATED CAPACITY OR ON OTHER PRODUCTS  
 WILL DAMAGE THE BLADES AND TOOL !**

## Cable Cutter RC-8

MADE  JAPAN

The tools for price sensitive **'professionals'**

Gives a clean cut without squashing thanks to the triangular cutting system / blades and centre.

Blades and center bolt in high-quality hardened steel for exceptional performance.

Thumb catch designed for one-handed operation.

Pressed steel handles with non-slip grips.









Model	Application	Max. Diameter	Overall Length	Weight lbs/pc	Product Code
 <b>RC 8</b>	Mild Steel Strand	1/4"	<b>195mm</b>	<b>0.63</b>	<b>30011007</b>
	High Tensile Steel Strand	3/16"			
	Hard Drawn Steel Spring Wire	3/32"			
	Mild Steel & Barbed Wire	3/16"			

**THESE TOOLS ARE SHARP AND SHOULD BE USED WITH CAUTION !  
 USING THEM BEYOND THE STATED CAPACITY OR ON OTHER PRODUCTS  
 WILL DAMAGE THE BLADES AND TOOL !**

# Hand Swagers

Swagers are designed for crimping Copper and Aluminum Oval and Stop Sleeves



Swagers Model	Application	Overall Length	Weight lbs/pc	Product Code
<b>HSC-350 Hand</b> 	Non Adjustable Hand Swager with cable cutting feature. Capable of swaging 1/16, 3/32 and 1/8"	14"	3.00	30031006
<b>HS-600 Hand</b> 	Non Adjustable Hand Swager with cable cutting feature. Capable of swaging 1/16, 3/32, 1/8, 5/32 and 3/16"	25-1/2"	5.50	30031002
<b>HS-600 Bench</b> 	Non Adjustable Bench Swager with cable cutting feature. Capable of swaging 1/16, 3/32, 1/8, 5/32 and 3/16"	21-1/4"	11.00	30031001
<b>HS-1000</b> 	Non Adjustable Hand Swager Capable of swaging 1/4 and 5/16"	40"	17.00	30031010
<b>1/16" Hand</b> 	Non Adjustable Mini hand swager Capable of swaging 1/16"	22"	4.50	30031004
<b>0-Size Hand</b> 	Non Adjustable Single hole swager Sizes available, 3/32, 1/8, 3/16, 1/4 and 5/16"			

**WARNING:** THE SWAGING OF COMPRESSION FITTINGS DIRECTLY OVER PLASTIC COVERED WIRE ROPE WILL RESULT IN SEVERELY REDUCED HOLDING POWER AND IS NOT RECOMMENDED PARTICULARLY IN APPLICATIONS WHERE HUMAN SAFETY, LIFTING OR FULL WIRE STRENGTH IS INVOLVED. WE RECOMMEND REMOVING SUFFICIENT PLASTIC JACKET AND SWAGING THE PROPER SIZE SLEEVES DIRECTLY ON THE BARE WIRE.

# Swaging Instructions

Crimps	Cable Size	Position
1	1/16	<b>1</b>
1	5/64	
2	3/32	<b>2</b>
2	7/64	
3	1/8	<b>3</b>
3	5/32	<b>4</b>
3	3/16	<b>5</b>

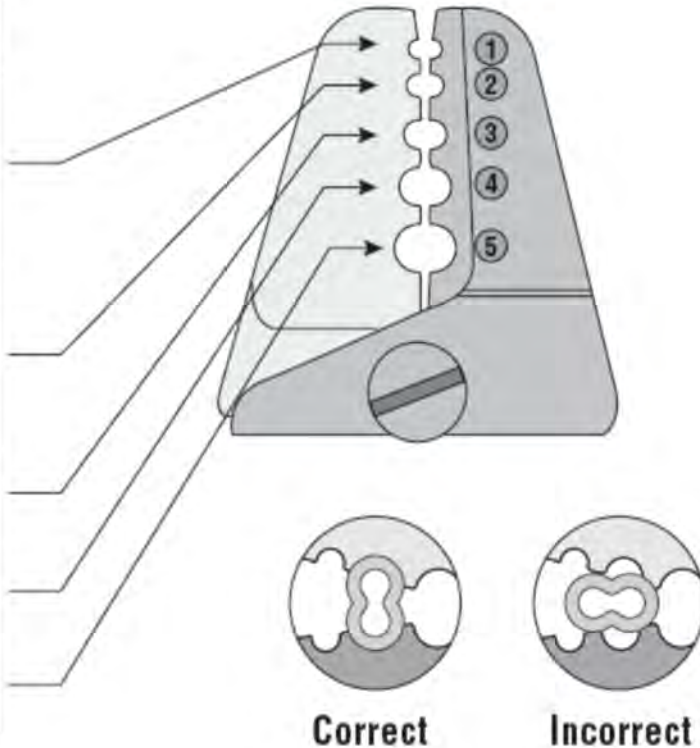

1. Cut cable to the required length and lace the cable through the sleeve so that the end will protrude after crimping.
2. Properly insert sleeve into the correct cavity and line up the sleeve between the swager jaws with the long axis crosswise to the jaws.
3. Swage each sleeve the correct number of times following the swage sequence shown. Close lever handles completely until the swager snaps shut indicating complete closure.
4. Lap splice can be made by 2 oval sleeves. Keep a short space between the sleeves.

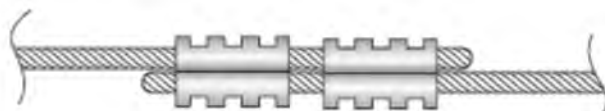
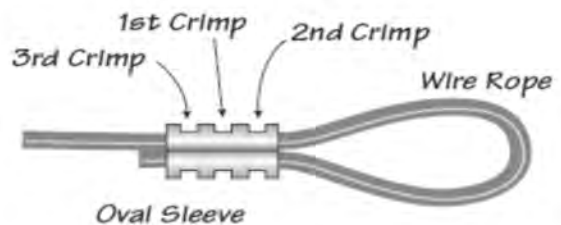
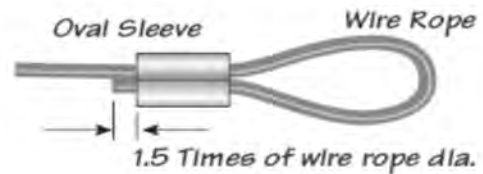

**Swaging is accomplished on bare wire rope. If plastic wire rope is used, remove plastic coating as required.** Properly swaged oval sleeves will develop the published nominal breaking strength of the cable on 3 x 7; 7 x 7; and 7 x 19 constructions. Sleeves used on other constructions will **not** hold to the nominal published breaking strength.





### General Warnings

All Vanguard rigging products are sold with the express understanding that both the purchaser and the end user are thoroughly familiar with the safe, proper and acceptable applications of the products.

It is the responsibility of the end user to establish proper safety programs and to provide thorough training for all personnel prior to use. The training programs must meet any federal/provincial/state/local code requirements, existing plant/site safety rules and regulations, and all instructions provided in the applicable section of this catalogue.

Product failure can occur due to abuse, misapplication, lack of maintenance, use by unqualified personnel and improper inspection prior to use. **Any failure of rigging products may result in property damage, personal injury and even death!!!!**

### Standards

There are numerous government and industrial standards that cover rigging products. This catalogue makes no attempt to reference all of them; it references to the standards that are most frequently asked about.

### Working Load Limit (WLL) – Safe Working Load (SWL)

The Working Load Limits shown in this catalogue are applicable to products that are new or “in as new” condition. The Working Load Limits ratings refer to the maximum amount of force or load that the rigging product can carry under normal working/environmental conditions. The Working Load Limits and Design Factor can be affected by wear, misuse, overloading, shock loading, side loading, corrosion, deformation, product alteration and other use conditions. Inspection of rigging products prior to use is required to determine whether the product continues to meet the assigned WLL provided in this catalogue, should be used at a reduced rating or removed from service.

**The WLL rating must never be exceeded!!!!**



### General information disclaimer

The contents contained in this publication are for general information only.

Although every effort has been made to assure the accuracy of the information at time of print, persons who use the Catalog should note that ratings, laws, rules, and policies change from time to time and that these changes may alter the information contained in this publication.

Vanguard Steel Ltd. assumes no liability for Catalog errors or omissions.

It is the responsibility of each person who uses this Catalog to ascertain current information that pertains to the individual lifting program, particularly with regard to satisfactory safety compliance requirements. Check your Provincial and Local safety standards before any operation or lift is attempted.

It is the responsibility of the person/operator to frequently search for updated reference information.

Do not use lesser than matching Grade components for any lifting application !

Do not use Slings, Chains or Accessories with signs of wear or deformation !

Inspections - Each day before being used, the sling and all fastenings and attachments shall be inspected for damage or defects by a competent person designated by the employer. Additional inspections shall be performed during sling use where service conditions warrant. Damaged or defective slings shall be immediately removed from service.