

# HOOKS





# HOOKS TABLE OF CONTENTS

	Page
Alloy Clevis Grab	1
Alloy Clevis Slip	2
Alloy Clevis Slip with Latch Kit	3
Barrel	4
Carbon Clevis Grab	5
Carbon Clevis Slip	6
Eye Grab	7
Eye Hooks Alloy	8
Eye Hooks Alloy Swivel	9
Eye Hooks Carbon	10
Eye Hooks Carbon Swivel	11
Eye Slip	12
Latch Kits	13
Sorting	14
Weld On	15

# 'Black Pin' ® -Alloy Clevis Grab Hooks

For use with Grade 70 or lower grade chains only.  
Gold chromate body with 'black pin'.



Size	WLL (lbs)	Dimension Inches				Weight (lbs pc)	Product Code
		A	B	C	D		
1/4"	3,150	0.36	0.38	0.39	1.97	0.46	39310016
5/16"	4,700	0.38	0.44	0.43	2.28	0.75	39310020
3/8"	6,600	0.47	0.47	0.50	2.61	1.10	39310024
7/16"	8,800	0.67	0.55	0.58	2.79	1.53	39310028
1/2"	11,300	0.76	0.62	0.67	3.13	2.34	39310032

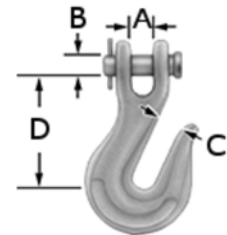

**NOTE :** Forged Alloy Steel, heat treated  
Design Factor 4 : 1

**WARNING :** NEVER EXCEED WORKING LOAD LIMITS !  
DO NOT USE GRADE 40 OR 70 FOR OVERHEAD LIFTING APPLICATIONS !  
Inspect hooks and latches frequently-Measure opening (C) and compare with dimensions shown  
Increased opening indicates overloading !  
Discard hooks which show signs of deformation or excessive wear !

# 'Black Pin' ® -Alloy Clevis Slip Hooks

For use with Grade 70 or lower grade chains only.  
Gold chromate body with 'black pin'.

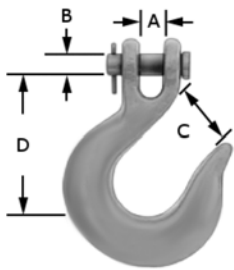

Size	WLL (lbs)	Dimension Inches				Weight (lbs pc)	Product Code
		A	B	C	D		
1/4"	2,750	0.43	0.38	0.98	2.52	0.65	39031016
5/16"	4,300	0.51	0.43	1.10	2.82	0.92	39031020
3/8"	5,250	0.58	0.47	1.33	3.22	1.32	39031024
7/16"	7,000	0.67	0.54	1.61	3.69	2.07	39031028
1/2"	9,000	0.76	0.62	1.74	3.99	2.90	39031032

**NOTE :** Forged Alloy Steel, heat treated  
Design Factor 4 : 1

**WARNING :** NEVER EXCEED WORKING LOAD LIMITS !  
DO NOT USE GRADE 40 OR 70 FOR OVERHEAD LIFTING APPLICATIONS !  
Inspect hooks and latches frequently-Measure opening (C) and compare with dimensions shown  
Increased opening indicates overloading !  
Discard hooks which show signs of deformation or excessive wear !

# 'Black Pin' ® -Alloy Clevis Slip Hooks with Latch

For use with Grade 70 or lower grade chains only.  
Gold chromate body with 'black pin'.



Size	WLL (lbs)	Dimension Inches				Weight (lbs pc)	Product Code
		A	B	C	D		
1/4"	2,750	0.43	0.38	0.98	2.52	0.65	390310161
5/16"	4,300	0.51	0.43	1.10	2.82	0.92	390310201
3/8"	5,250	0.58	0.47	1.33	3.22	1.32	390310241
7/16"	7,000	0.67	0.54	1.61	3.69	2.07	390310281
1/2"	9,000	0.76	0.62	1.74	3.99	2.90	390310321

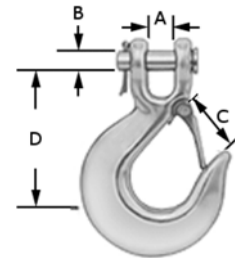

**NOTE :** Forged Alloy Steel, heat treated  
Design Factor 4 : 1

## STAINLESS STEEL - LATCH KITS

1/4"						0.02	3903 20161
5/16"						0.02	3903 20201
3/8"						0.03	3903 20241
7/16"						0.03	3903 20281
1/2"						0.06	3903 20321



### WARNING : NEVER EXCEED WORKING LOAD LIMITS !

**DO NOT USE GRADE 40 OR 70 FOR OVERHEAD LIFTING APPLICATIONS !**  
Inspect hooks and latches frequently-Measure opening (C) and compare with dimensions shown  
Increased opening indicates overloading !  
Discard hooks which show signs of deformation or excessive wear !

# Barrel Hooks

Forged Carbon Steel, quenched and tempered.

Meets the performance requirements of Federal Specifications RR-C-271D, Type V, Class 6, except for those provisions required by the contractor.

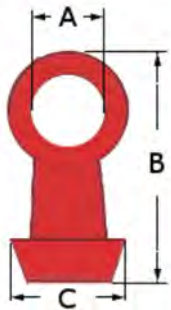

Size Tons	WLL Tons		Dimension Inches			Weight (lbs pc)	Product Code
	Tip	Bottom	A	B	C		
1	2	7.5	1-1/2	4-1/2	2-3/8	6.25	37030050

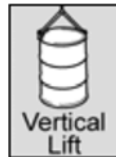

NOTE :

Forged Carbon Steel, heat treated  
Design Factor 4 : 1

**WARNING :** NEVER EXCEED WORKING LOAD LIMITS !  
Use only Alloy Chain and attachment for overhead lifting

# 'Golden Pin' ® - Carbon Clevis Grab Hooks

For use with Grade 40 or lower chains only.  
Self coloured body with 'golden pin'.



Size	WLL (lbs)	Dimension Inches				Weight (lbs pc)	Product Code
		A	B	C	D		
1/4"	2,600	0.35	0.38	0.39	1.97	0.45	39300016
5/16"	3,900	0.41	0.43	0.44	2.27	0.74	39300020
3/8"	5,400	0.47	0.47	0.51	2.63	1.14	39300024
7/16"	7,200	0.67	0.55	0.58	2.79	1.45	39300028
1/2"	9,200	0.73	0.62	0.69	3.13	2.30	39300032

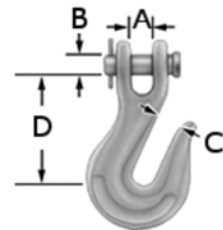

**NOTE :** Forged Carbon Steel, heat treated  
Design Factor 4 : 1

**WARNING :** NEVER EXCEED WORKING LOAD LIMITS !  
DO NOT USE GRADE 40 OR 70 FOR OVERHEAD LIFTING APPLICATIONS !  
Inspect hooks and latches frequently-Measure opening (C) and compare with dimensions shown  
Increased opening indicates overloading !  
Discard hooks which show signs of deformation or excessive wear !

# 'Golden Pin' ® - Carbon Clevis Slip Hooks

For use with Grade 40 or lower chains only.  
Self coloured body with 'golden pin'.

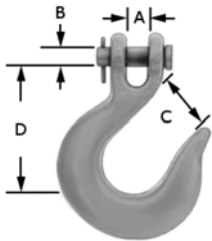

Size	WLL (lbs)	Dimension Inches				Weight (lbs pc)	Product Code
		A	B	C	D		
1/4"	1,950	0.43	0.37	0.98	2.61	0.65	39030016
5/16"	2,875	0.50	0.43	1.08	2.81	0.91	39030020
3/8"	4,000	0.58	0.48	1.37	3.24	1.30	39030024
7/16"	5,000	0.67	0.55	1.59	3.70	2.18	39030028
1/2"	6,500	0.75	0.64	1.73	3.95	3.00	39030032

**NOTE :** Forged Carbon Steel, heat treated  
Design Factor 4 : 1

**WARNING :** NEVER EXCEED WORKING LOAD LIMITS !  
DO NOT USE GRADE 40 OR 70 FOR OVERHEAD LIFTING APPLICATIONS !  
Inspect hooks and latches frequently-Measure opening (C) and compare with dimensions shown  
Increased opening indicates overloading !  
Disgard hooks which show signs of deformation or excessive wear !



# Eye Grab Hooks

For use with Grade 40 or lower chains only.



Size	WLL (lbs)	Dimension Inches			Weight (lbs pc)	Product Code
		A	B	C		
1/4"	2,600	0.53	1.92	0.34	0.30	39335016
5/16"	3,900	0.61	2.29	0.43	0.51	39335020
3/8"	5,400	0.80	2.65	0.49	0.88	39335024
1/2"	9,200	0.89	3.21	0.65	1.79	39335032

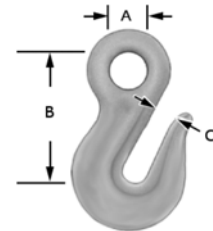

**NOTE :** Forged Carbon Steel, heat treated  
Design Factor 4 : 1

**WARNING :** NEVER EXCEED WORKING LOAD LIMITS !  
DO NOT USE GRADE 40 OR 70 FOR OVERHEAD LIFTING APPLICATIONS !  
Inspect hooks and latches frequently-Measure opening (C) and compare with dimensions shown  
Increased opening indicates overloading !  
Discard hooks which show signs of deformation or excessive wear !

# 'Black Eye' ® - Alloy Steel Hoist Hooks

Alloy Steel, quenched and tempered.  
 Embossed Working Load Limit (WLL) with 5 : 1 safety factor.  
 Colour coding prevents mix-ups. Alloy Steel-Black Eye, Gold body.

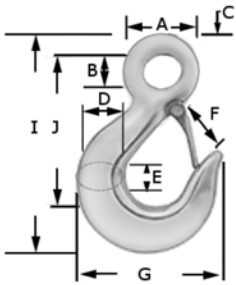

WLL (Tons)	Dimension Inches										Weight (lbs)	Product Code
	A	B	C	D	E	F	G	H	I	J		
1	1.50	0.75	0.38	0.88	0.63	0.94	2.88	0.75	4.38	3.25	0.50	29101010
1-1/2	1.75	0.88	0.44	1.00	0.69	1.06	3.13	0.81	4.88	3.63	0.80	29101015
2	2.00	1.13	0.50	1.19	0.81	1.12	3.50	1.00	5.50	4.13	1.10	29101020
3	2.38	1.25	0.59	1.38	0.94	1.22	3.94	1.19	6.31	4.56	1.70	29101030
4-1/2	3.00	1.56	0.69	1.63	1.19	1.50	5.00	1.50	7.94	5.75	3.60	29101045
7	3.81	2.00	0.88	2.06	1.50	1.88	6.25	1.75	10.00	7.38	7.00	29101070
11	4.70	2.43	1.19	2.53	1.68	2.23	7.25	2.37	12.25	9.00	13.27	29101110

**NOTE :** Alloy Steel, heat treated  
 Recommended maximum proof load 2 x WLL

For replacement latches see page 13

**WARNING :** NEVER EXCEED WORKING LOAD LIMITS !  
 Inspect hooks and latches frequently-Measure opening (F) and compare with dimensions shown  
 Increased opening indicates overloading !  
 Discard hooks which show signs of deformation or excessive wear !  
 Latches are not designed to support loads-replace bent latches  
 Always use thimbles to install hooks onto a rope

# 'Black Eye' ® - Alloy Steel Swivel Hooks

Forged Alloy Steel, quenched and tempered.

Embossed Working Load Limit (WLL) with 4.5 : 1 safety factor.

Colour coding prevents mix-ups. Alloy Steel-Black Eye Swivel, Gold body.



WLL (Tons)	Dimension Inches										Weight (lbs)	Product Code
	A	B	C	D	E	F	G	H	I	J		
1	1.23	0.92	0.40	0.83	0.60	0.98	2.95	0.86	5.50	4.35	0.81	29281010
1-1/2	1.50	1.35	0.52	0.94	0.66	1.07	3.33	0.86	6.50	5.23	1.41	29281015
2	1.73	1.70	0.64	1.13	0.75	1.10	3.75	1.04	7.50	6.00	2.24	29281020
3	1.70	1.60	0.64	1.36	0.87	1.21	4.25	1.20	8.00	6.25	2.74	29281030
4-1/2	1.95	1.84	0.78	1.66	1.11	1.52	5.00	1.55	9.50	7.50	4.71	29281045
7	2.42	2.42	1.02	2.10	1.35	2.04	7.00	1.99	11.75	9.75	10.30	29281070
11	2.70	2.51	1.10	2.65	1.75	2.40	8.00	2.45	14.50	11.12	16.15	29281110
15	4.10	3.76	1.50	3.50	2.69	3.41	10.34	3.00	21.34	16.71	46.50	29281150
22	4.10	3.76	1.50	4.63	3.00	4.00	13.62	3.61	23.25	18.01	70.00	29281220

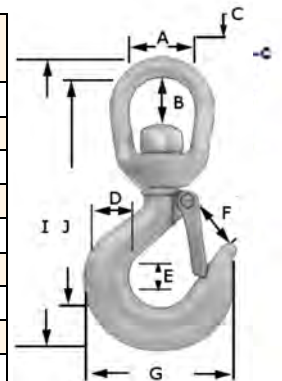

**NOTE :** Alloy Steel, heat treated  
Recommended maximum proof load 2 x WLL

For replacement latches see page 13

**WARNING :** NEVER EXCEED WORKING LOAD LIMITS !  
 Inspect hooks and latches frequently-Measure opening (F) and compare with dimensions shown  
 Increased opening indicates overloading !  
 Discard hooks which show signs of deformation or excessive wear !  
 Latches are not designed to support loads-replace bent latches  
 Always use thimbles to install hooks onto a rope

# 'Black Eye' ® - Carbon Steel Hoist Hooks

Forged Carbon Steel, quenched and tempered.  
 Embossed Working Load Limit (WLL) with 5 : 1 safety factor.  
 Colour coding prevents mix-ups. Carbon Steel-Black Eye, Red body.

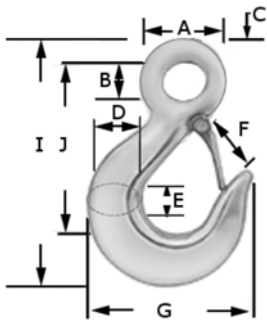

WLL (Tons)	Dimension Inches										Weight (lbs)	Product Code
	A	B	C	D	E	F	G	H	I	J		
1/2	0.56	0.62	0.35	0.75	0.53	0.76	2.55	0.75	3.83	2.75	0.38	29100005
3/4	1.50	0.75	0.38	0.88	0.63	0.94	2.88	0.75	4.38	3.25	0.50	29100007
1	1.75	0.88	0.44	1.00	0.69	1.06	3.13	0.81	4.88	3.63	0.80	29100010
1-1/2	2.00	1.13	0.50	1.19	0.81	1.12	3.50	1.00	5.50	4.13	1.10	29100015
2	2.38	1.25	0.59	1.38	0.94	1.22	3.94	1.19	6.31	4.56	1.70	29100020
3	3.00	1.56	0.69	1.63	1.19	1.50	5.00	1.50	7.94	5.75	3.60	29100030
5	3.81	2.00	0.88	2.06	1.50	1.88	6.25	1.75	10.00	7.38	7.00	29100050
7-1/2	4.70	2.43	1.19	2.53	1.68	2.23	7.25	2.37	12.25	9.00	13.27	29100075

**NOTE :** Carbon Steel, heat treated  
 Recommended maximum proof load 2 x WLL

For replacement latches see page 13

**WARNING : NEVER EXCEED WORKING LOAD LIMITS !**

- Inspect hooks and latches frequently-Measure opening (F) and compare with dimensions shown
- Increased opening indicates overloading !
- Discard hooks which show signs of deformation or excessive wear !
- Latches are not designed to support loads-replace bent latches
- Always use thimbles to install hooks onto a rope

# 'Black Eye' ® - Carbon Steel Swivel Hooks

Forged Carbon Steel, quenched and tempered.  
 Embossed Working Load Limit (WLL) with 5 : 1 safety factor.  
 Colour coding prevents mix-ups. Carbon Steel-Black Eye Swivel, Red body.



WLL (Tons)	Dimension Inches										Weight (lbs)	Product Code
	A	B	C	D	E	F	G	H	I	J		
3/4	1.23	0.92	0.40	0.83	0.60	0.98	2.95	0.86	5.50	4.35	0.81	29280010
1	1.50	1.35	0.52	0.94	0.66	1.07	3.33	0.86	6.50	5.23	1.41	29280011
1-1/2	1.73	1.70	0.64	1.13	0.75	1.10	3.75	1.04	7.50	6.00	2.24	29280015
2	1.70	1.60	0.64	1.36	0.87	1.21	4.25	1.20	8.00	6.25	2.74	29280020
3	1.95	1.84	0.78	1.66	1.11	1.52	5.00	1.55	9.50	7.50	4.71	29280030
5	2.42	2.42	1.02	2.10	1.35	2.04	7.00	1.99	11.75	9.50	10.30	29280050
7-1/2	2.70	2.51	1.10	2.65	1.75	2.40	8.00	2.45	14.50	11.12	16.15	29280075

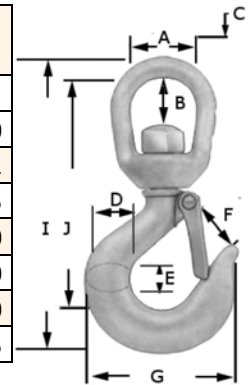

**NOTE :** Carbon Steel, heat treated  
 Recommended maximum proof load 2 x WLL

For replacement latches see page 13

**WARNING :** NEVER EXCEED WORKING LOAD LIMITS !  
 Inspect hooks and latches frequently-Measure opening (F) and compare with dimensions shown  
 Increased opening indicates overloading !  
 Discard hooks which show signs of deformation or excessive wear !  
 Latches are not designed to support loads-replace bent latches  
 Always use thimbles to install hooks onto a rope

## Eye Slip Hooks

For use with Grade 40 or lower chains only.



Size	WLL (lbs)	Dimension Inches			Weight (lbs pc)	Product Code
		A	B	C		
1/4"	1,950	0.50	2.54	0.94	0.49	39085016
5/16"	2,875	0.62	2.92	1.07	0.62	39085020
3/8"	4,000	0.73	3.34	1.33	0.98	39085024
1/2"	6,500	0.94	4.04	1.66	2.52	39085032

**NOTE :** Forged Carbon Steel, heat treated  
Design Factor 4 : 1

**WARNING :** NEVER EXCEED WORKING LOAD LIMITS !  
DO NOT USE GRADE 40 OR 70 FOR OVERHEAD LIFTING APPLICATIONS !  
Inspect hooks and latches frequently-Measure opening (C) and compare with dimensions shown  
Increased opening indicates overloading !  
Discard hooks which show signs of deformation or excessive wear !

# Stainless Steel Latch Kits

For Hoist Hooks.



WLL Tons		Dimensions inches				Weight (lbs pc)	Product Code
Carbon	Alloy	A	B	C	D		
3/4	1	0.44	0.16	1.44	0.59	0.02	29190010
1	1-1/2	0.44	0.16	1.70	0.59	0.02	29190011
1-1/2	2	0.45	0.17	1.84	0.77	0.03	29190021
2	3	0.47	0.17	2.00	0.82	0.03	29190022
3	4-1/2	0.56	0.19	2.41	1.00	0.06	29190030
5	7	0.58	0.20	2.97	1.21	0.11	29190050
7-1/2	11	0.59	0.27	3.66	1.50	0.17	29190075
10	15	0.66	0.27	3.69	1.52	0.25	29191509
15	22	0.78	0.27	3.86	1.59	0.75	29192209

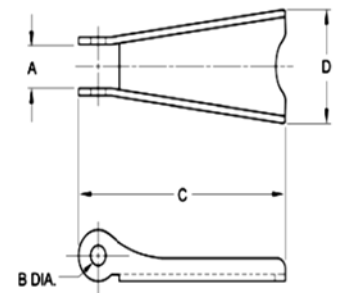

**WARNING :** NEVER EXCEED WORKING LOAD LIMITS !  
Latches are not designed to support loads - replace bent latches.

## Sorting Hooks

Forged Alloy Steel, quenched and tempered.  
 Deep straight throat permits efficient handling of flat plates or large cylindrical shapes.



Size Tons	WLL Tons		Dimension Inches				Weight (lbs pc)	Product Code
	Tip	Bottom	A	B	C	D		
7	2	7.5	9-11/16	1-3/8	2-13/16	5/8	6.25	29109120

**NOTE :** Forged Alloy Steel, heat treated  
 Design Factor 5 : 1

**WARNING :** NEVER EXCEED WORKING LOAD LIMITS !  
 Use only Alloy Chain and attachment for overhead lifting



## Weld on Hooks

Weld-On Grab Hook is a heavy-duty half grab hook that can be welded anywhere. Manufactured from high test steel, this half grab hook was designed to be welded anywhere you need a convenient chain attachment point. Originally used for automobile securement, this hook has become one of the most universally useful attachment points on the market.



Size	WLL (lbs)	Dimensions Inches			Weight (lbs pc)	Product Code
		A	B	C		
5/16"	3,900	2-1/2	2	3/8	0.42	3930 7020
3/8"	5,400	3	2-1/4	1/2	0.84	3930 7024
1/2"	9,200	4	3	5/8	1.90	3930 7032

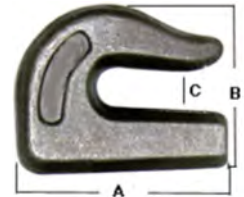

**WARNING : NEVER EXCEED WORKING LOAD LIMITS !**

Inspect hooks frequently-Measure opening (C) and compare with dimensions shown

Increased opening indicates overloading !

Discard hooks which show signs of deformation or excessive wear !



### General Warnings

All Vanguard rigging products are sold with the express understanding that both the purchaser and the end user are thoroughly familiar with the safe, proper and acceptable applications of the products.

It is the responsibility of the end user to establish proper safety programs and to provide thorough training for all personnel prior to use. The training programs must meet any federal/provincial/state/local code requirements, existing plant/site safety rules and regulations, and all instructions provided in the applicable section of this catalogue.

Product failure can occur due to abuse, misapplication, lack of maintenance, use by unqualified personnel and improper inspection prior to use. **Any failure of rigging products may result in property damage, personal injury and even death!!!!**

### Standards

There are numerous government and industrial standards that cover rigging products. This catalogue makes no attempt to reference all of them; it references to the standards that are most frequently asked about.

### Working Load Limit (WLL) – Safe Working Load (SWL)

The Working Load Limits shown in this catalogue are applicable to products that are new or “in as new” condition. The Working Load Limits ratings refer to the maximum amount of force or load that the rigging product can carry under normal working/environmental conditions. The Working Load Limits and Design Factor can be affected by wear, misuse, overloading, shock loading, side loading, corrosion, deformation, product alteration and other use conditions. Inspection of rigging products prior to use is required to determine whether the product continues to meet the assigned WLL provided in this catalogue, should be used at a reduced rating or removed from service.

**The WLL rating must never be exceeded!!!!**



### General information disclaimer

The contents contained in this publication are for general information only.

Although every effort has been made to assure the accuracy of the information at time of print, persons who use the Catalog should note that ratings, laws, rules, and policies change from time to time and that these changes may alter the information contained in this publication.

Vanguard Steel Ltd. assumes no liability for Catalog errors or omissions.

It is the responsibility of each person who uses this Catalog to ascertain current information that pertains to the individual lifting program, particularly with regard to satisfactory safety compliance requirements. Check your Provincial and Local safety standards before any operation or lift is attempted.

It is the responsibility of the person/operator to frequently search for updated reference information.

Do not use lesser than matching Grade components for any lifting application !

Do not use Slings, Chains or Accessories with signs of wear or deformation !

Inspections - Each day before being used, the sling and all fastenings and attachments shall be inspected for damage or defects by a competent person designated by the employer. Additional inspections shall be performed during sling use where service conditions warrant. Damaged or defective slings shall be immediately removed from service.